

CHLORIDE TEST FOR CONCRETE

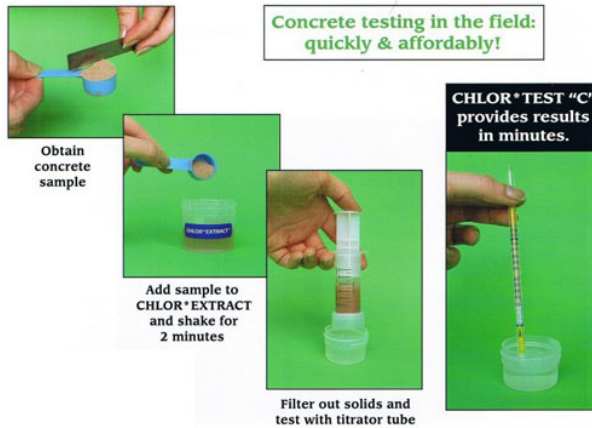

Detect and measure chlorides in concrete. Chloride penetration into concrete frequently causes corrosion of rebar and other steel. **Chlor*Test "C"** is the only complete and easy to use concrete test kit - even an inexperienced person can get accurate results.



Cross contamination, from test to test, is eliminated through one time use of individual components. The components are pre-measured to ensure accurate results in parts per million. In addition no temperature correction is needed from 41F to 176F.

Use this innovative product confidently on your project.